

The Mi7 Pivot Ball Conversion offers a substantial weight saving, improved suspension geometry, flex characteristics, and easier maintenance.

Bumper Modification

The bumper must be modified to clear the front wishbones. Using a scalpel or dremel, remove material as shown, paying attention to the 25° angle.

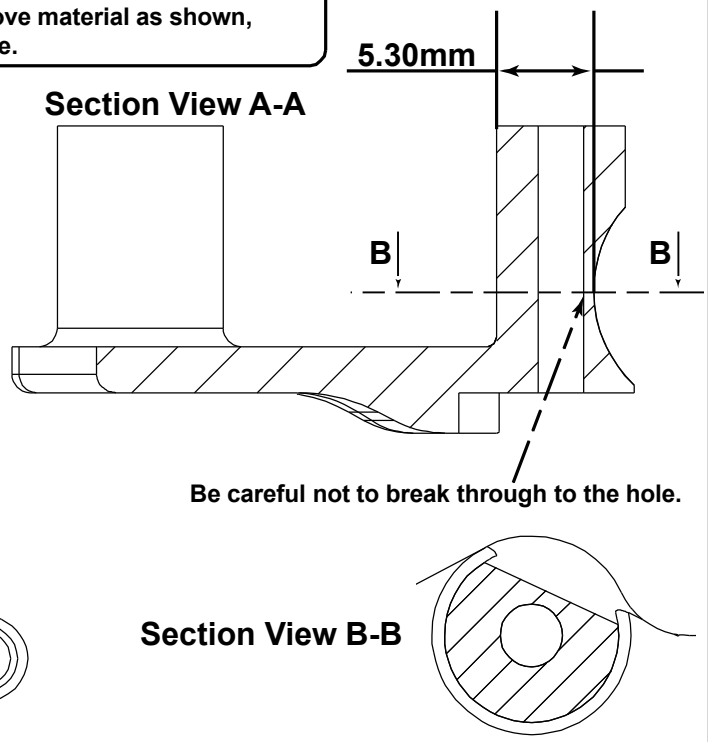
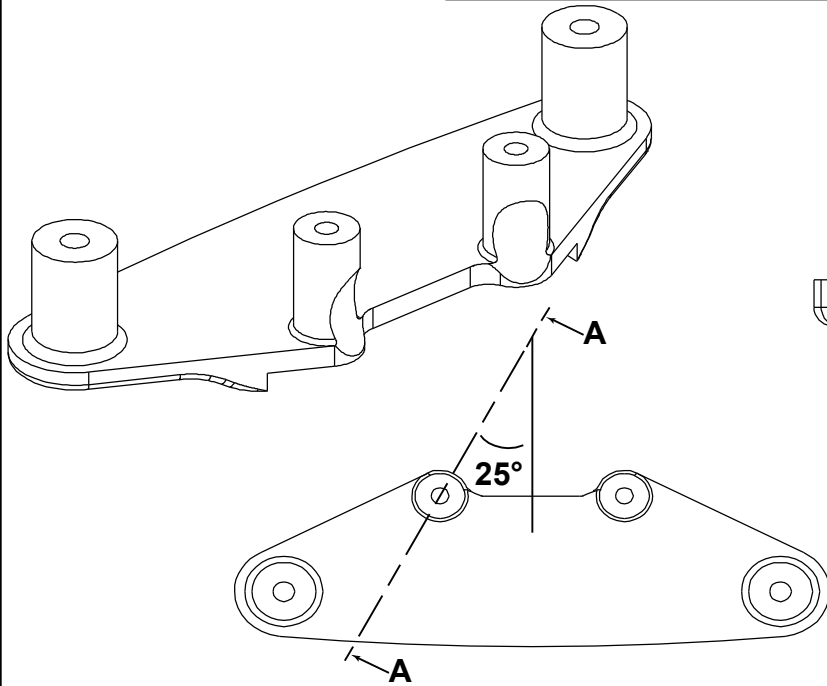

Bag A - Step 1

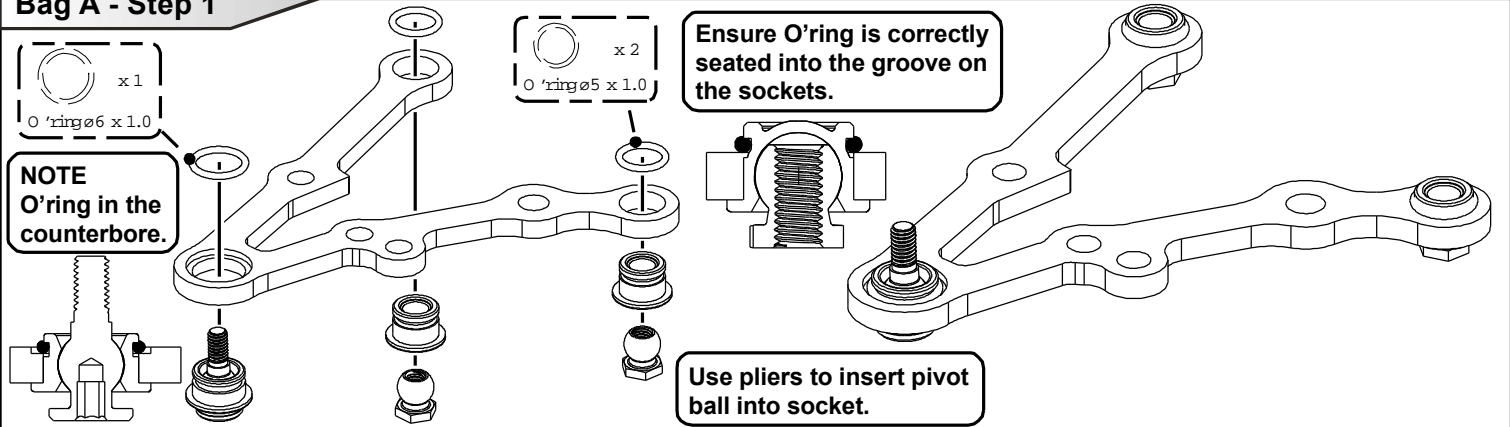

Bag A - Step 2

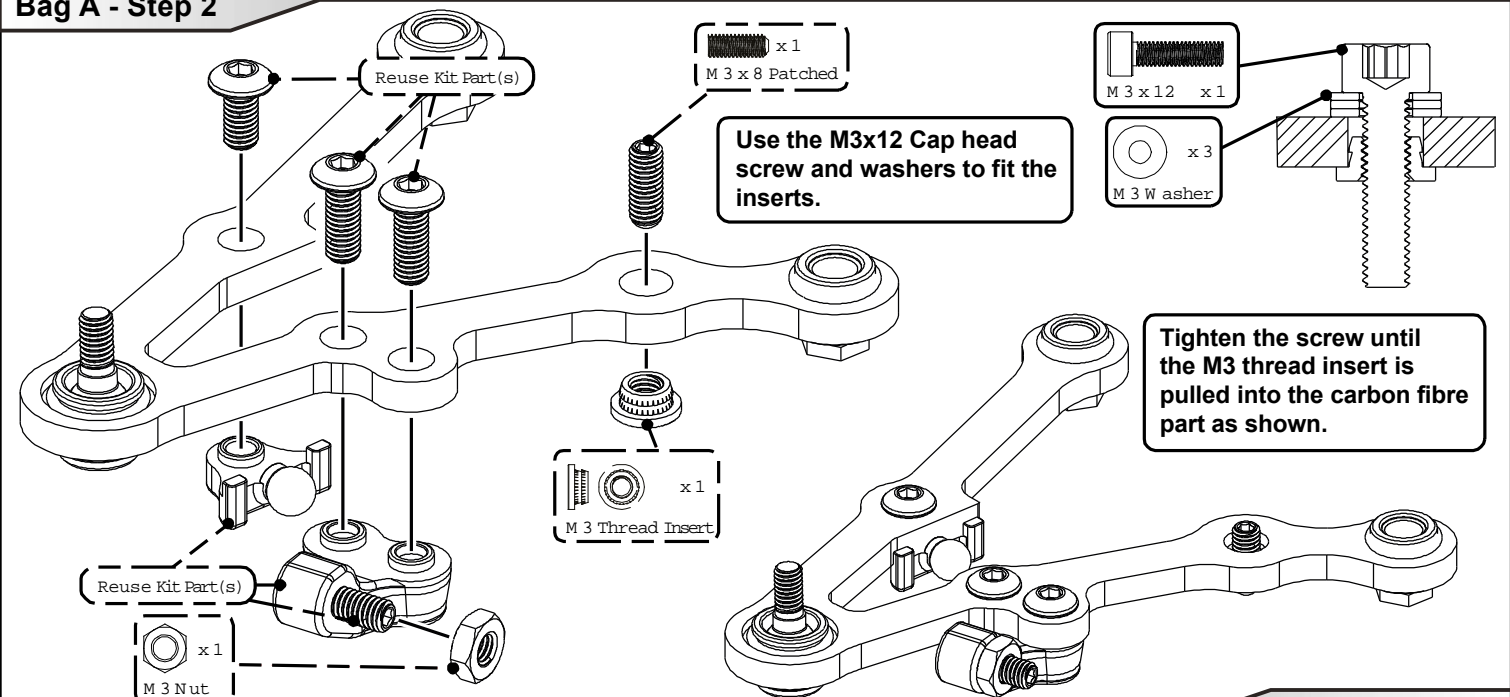

Bag A - Step 3

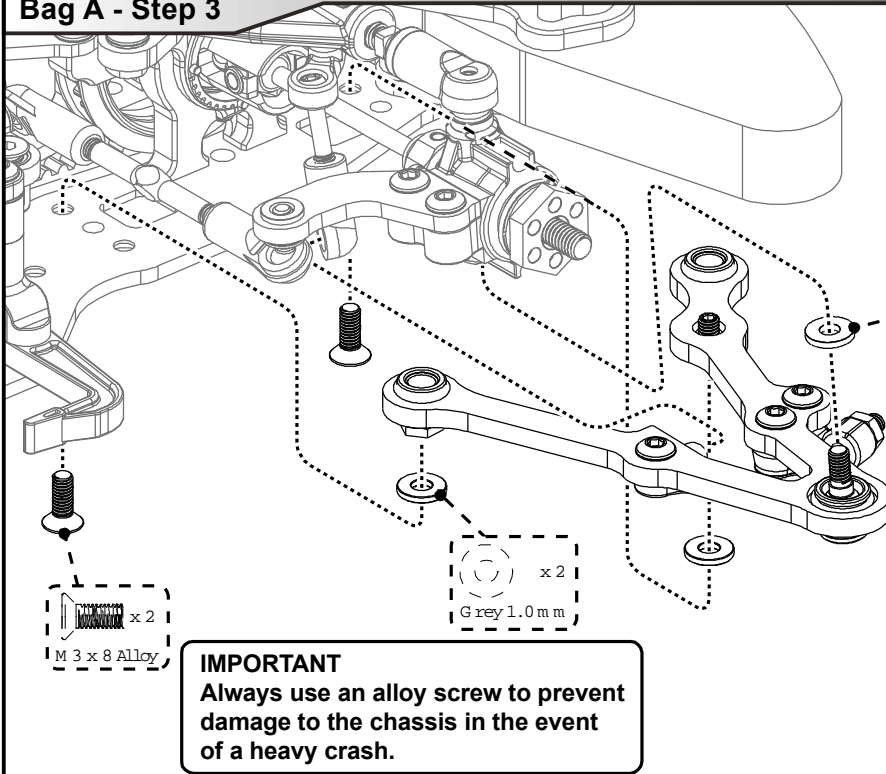

IMPORTANT
Only use the Ball Stud Washer (Shiny, silver, magnetic washer) in the specified location. If a normal washer is used it will lock up the ball joint.

x 1
Ball Stud Washer

x 2
M 3 x 8 Alloy

x 2
Grey 1.0mm

IMPORTANT
Always use an alloy screw to prevent damage to the chassis in the event of a heavy crash.

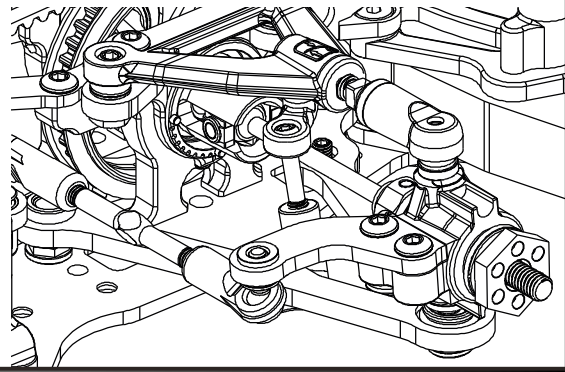

Bag B - Step 1

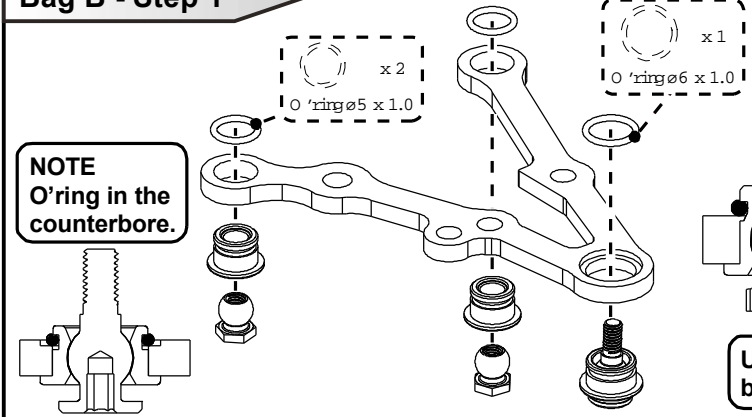

NOTE
O'ring in the counterbore.

x 2
O'ring $\varnothing 5 \times 1.0$

x 1
O'ring $\varnothing 6 \times 1.0$

Ensure O'ring is correctly seated into the groove on the sockets.

Use pliers to insert pivot ball into socket.

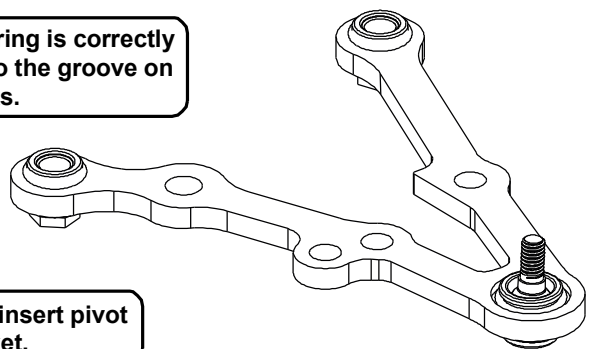

Bag B - Step 2

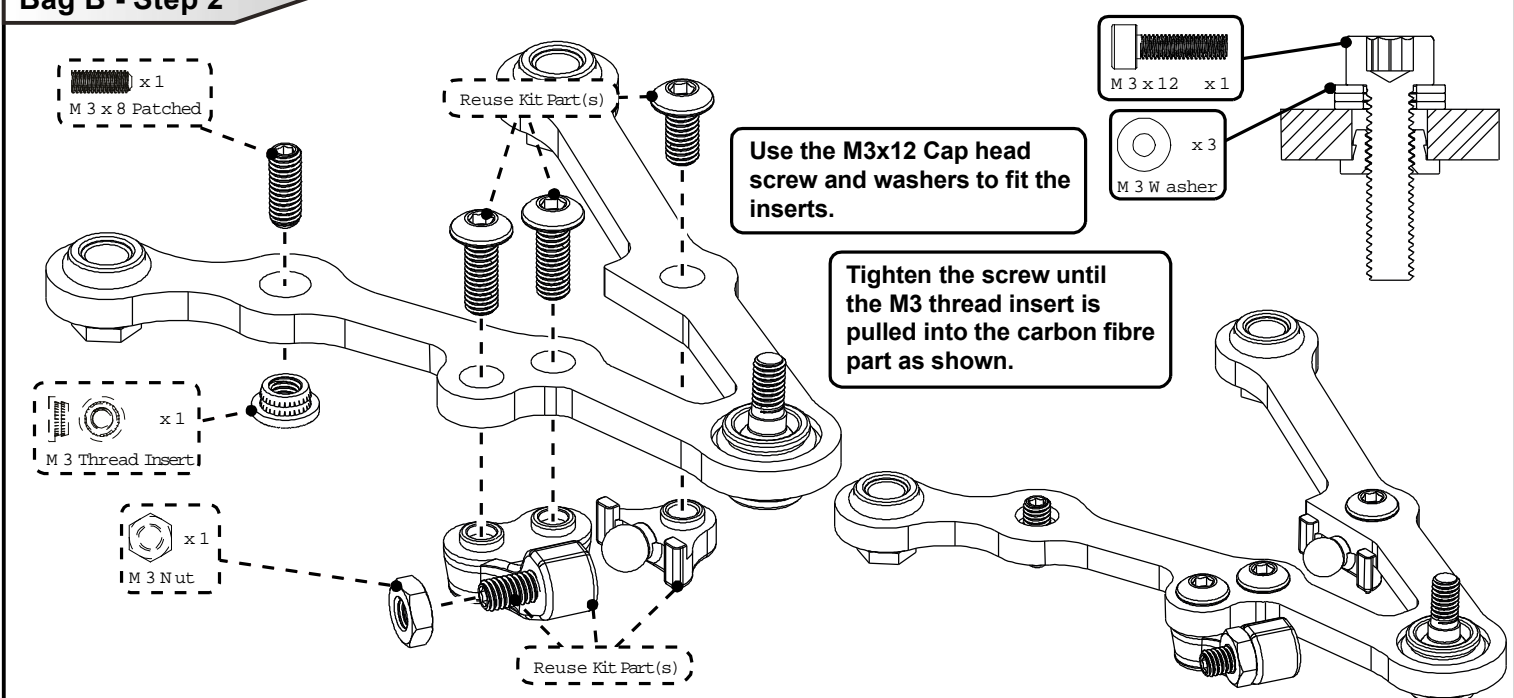

x 1
M 3 x 8 Patched

Reuse Kit Part(s)

Use the M3x12 Cap head screw and washers to fit the inserts.

x 1
M 3 x 12

x 3
M 3 Washer

Tighten the screw until the M3 thread insert is pulled into the carbon fibre part as shown.

x 1
M 3 Thread Insert

x 1
M 3 Nut

Reuse Kit Part(s)

Bag B - Step 3

IMPORTANT
Only use the Ball Stud Washer (Shiny, silver, magnetic washer) in the specified location. If a normal washer is used it will lock up the ball joint.

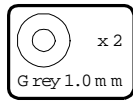
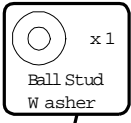

IMPORTANT
Always use an alloy screw to prevent damage to the chassis in the event of a heavy crash.

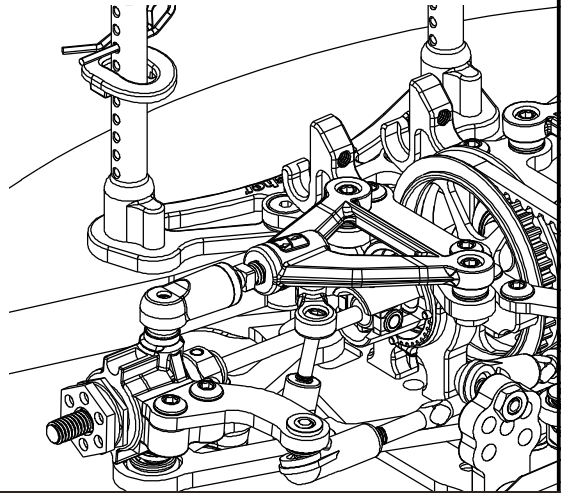
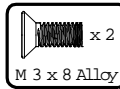

Bag C - Step 1

NOTE
O'ring in the counterbore.

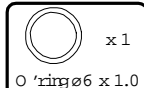
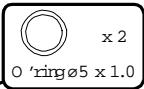

Ensure O'ring is correctly seated into the groove on the sockets.

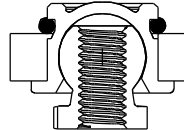

Use pliers to insert pivot ball into socket.

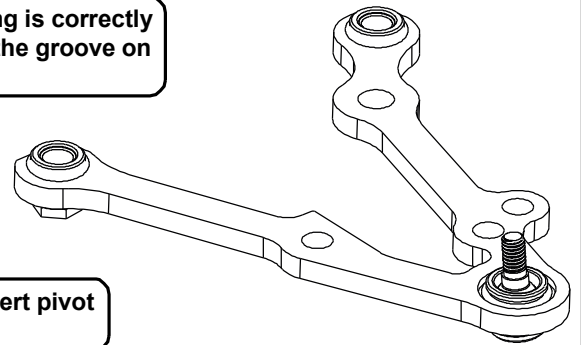

Bag C - Step 2

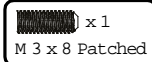

Use the M3x12 Cap head screw and washers to fit the inserts.

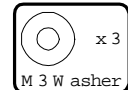
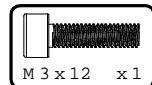

Tighten the screw until the M3 thread insert is pulled into the carbon fibre part as shown.

Reuse Kit Part(s)

Reuse Kit Part(s)

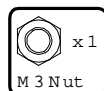

Reuse Kit Part(s)

Reuse Kit Part(s)

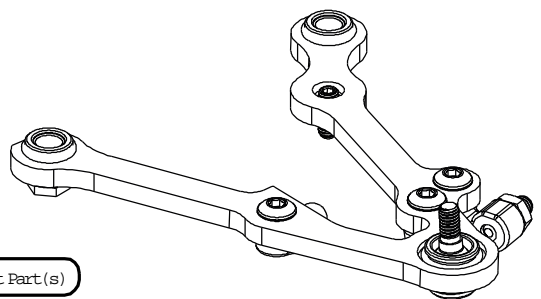
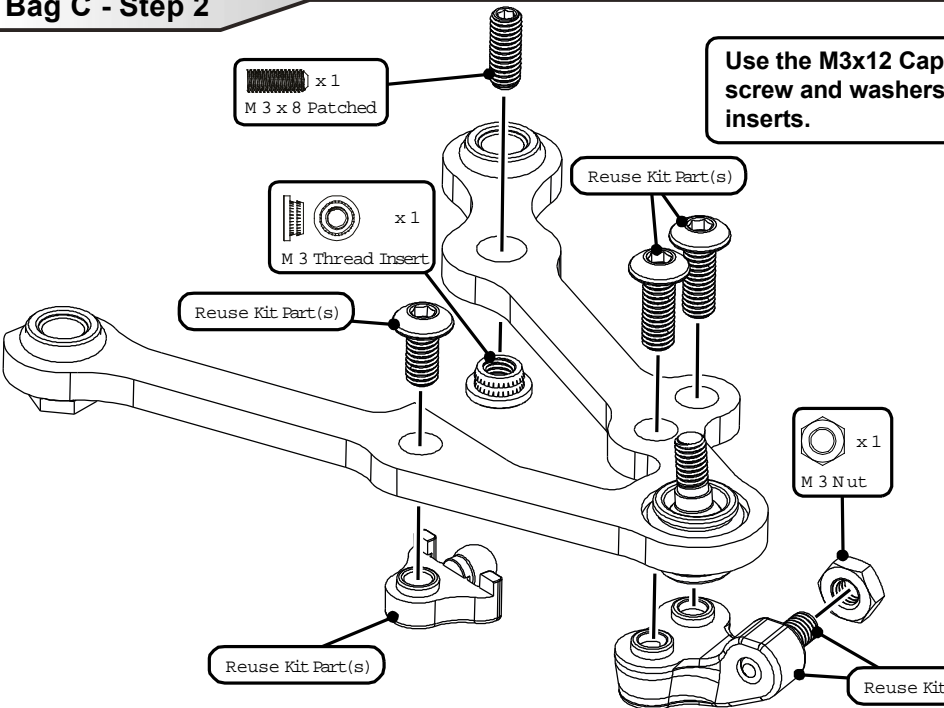

Bag C - Step 3

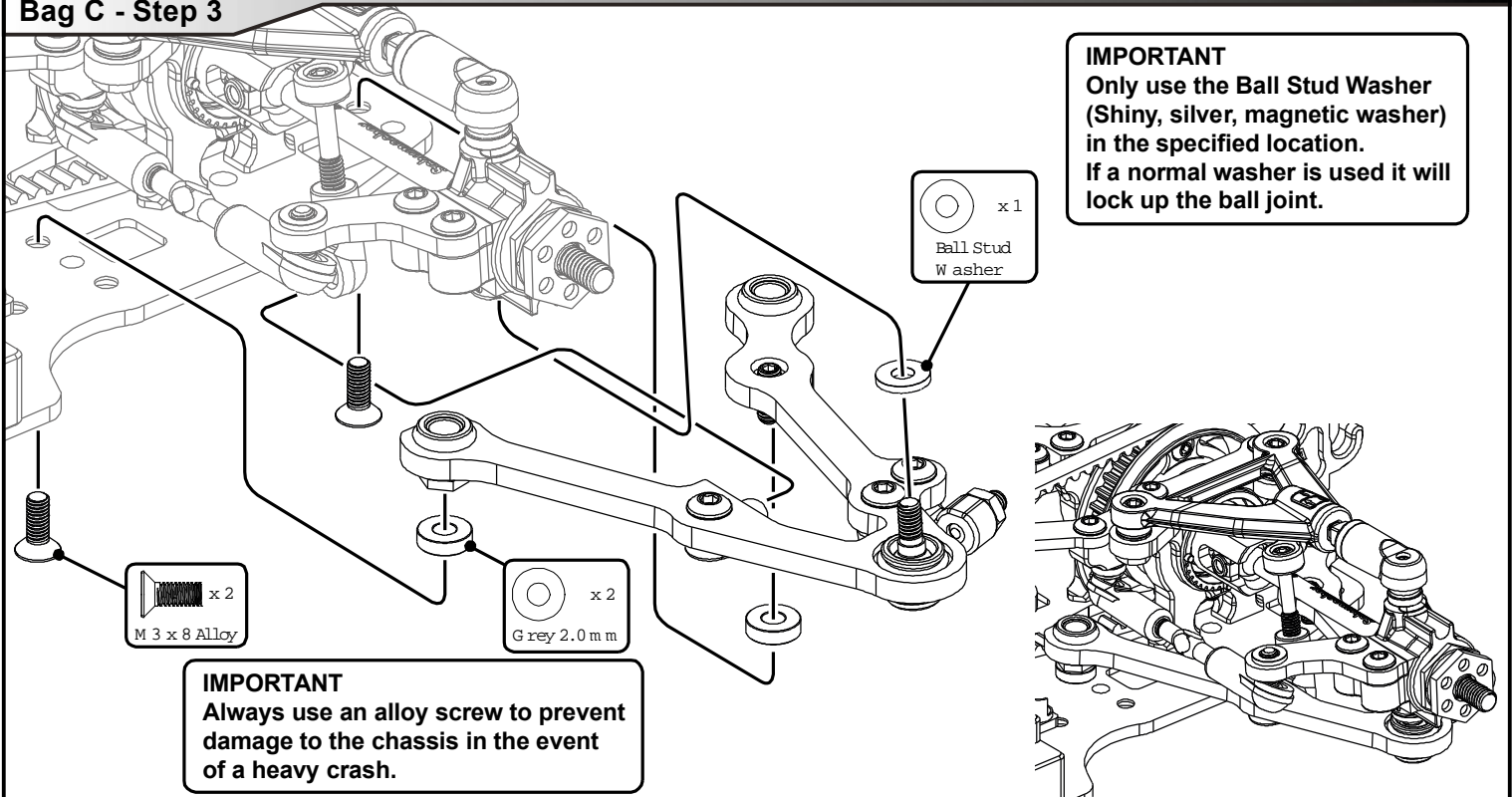

Bag D - Step 1

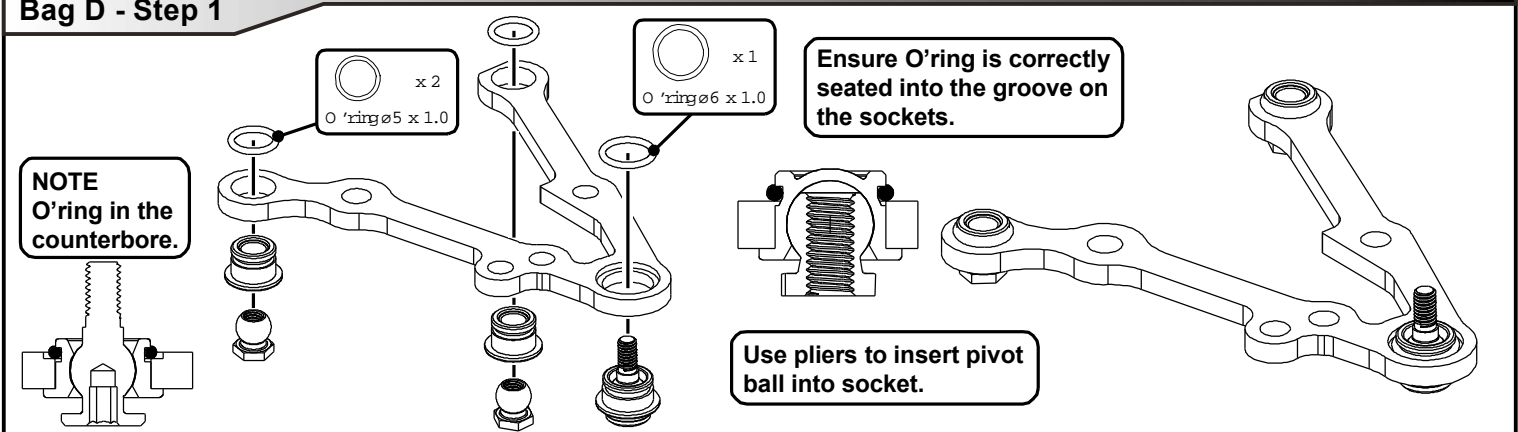

Bag D - Step 2

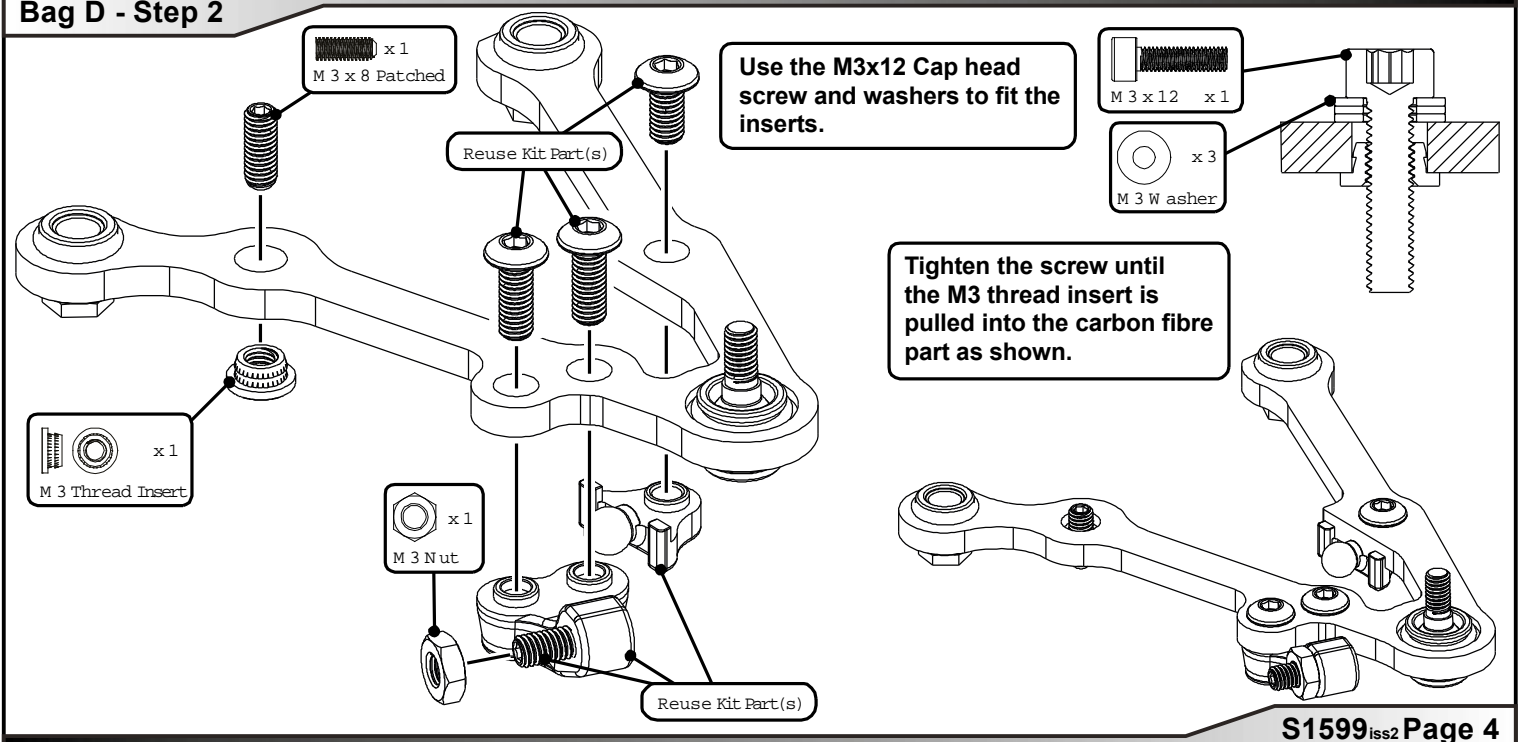

Bag D - Step 3

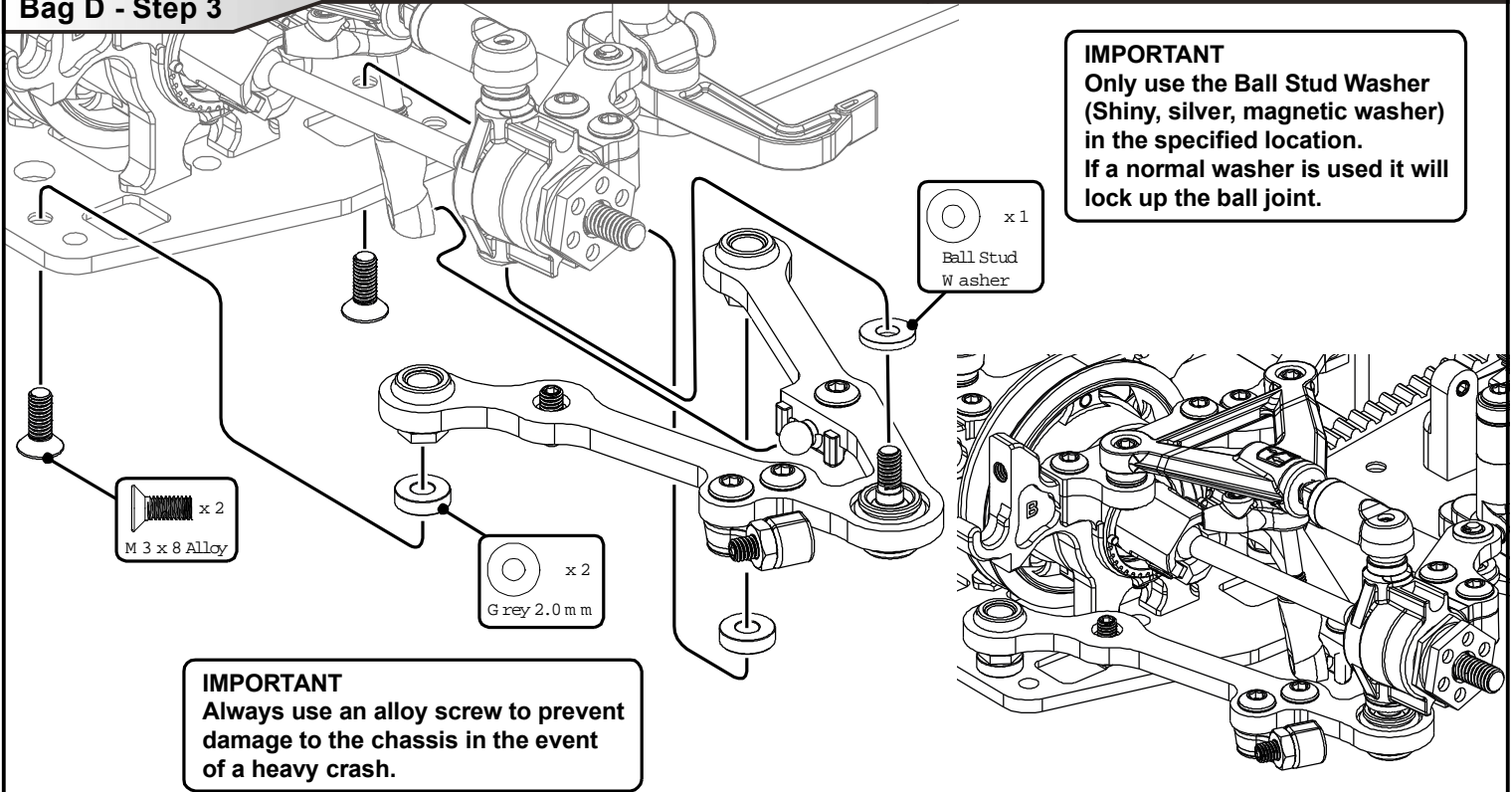

Bag E - Step 1

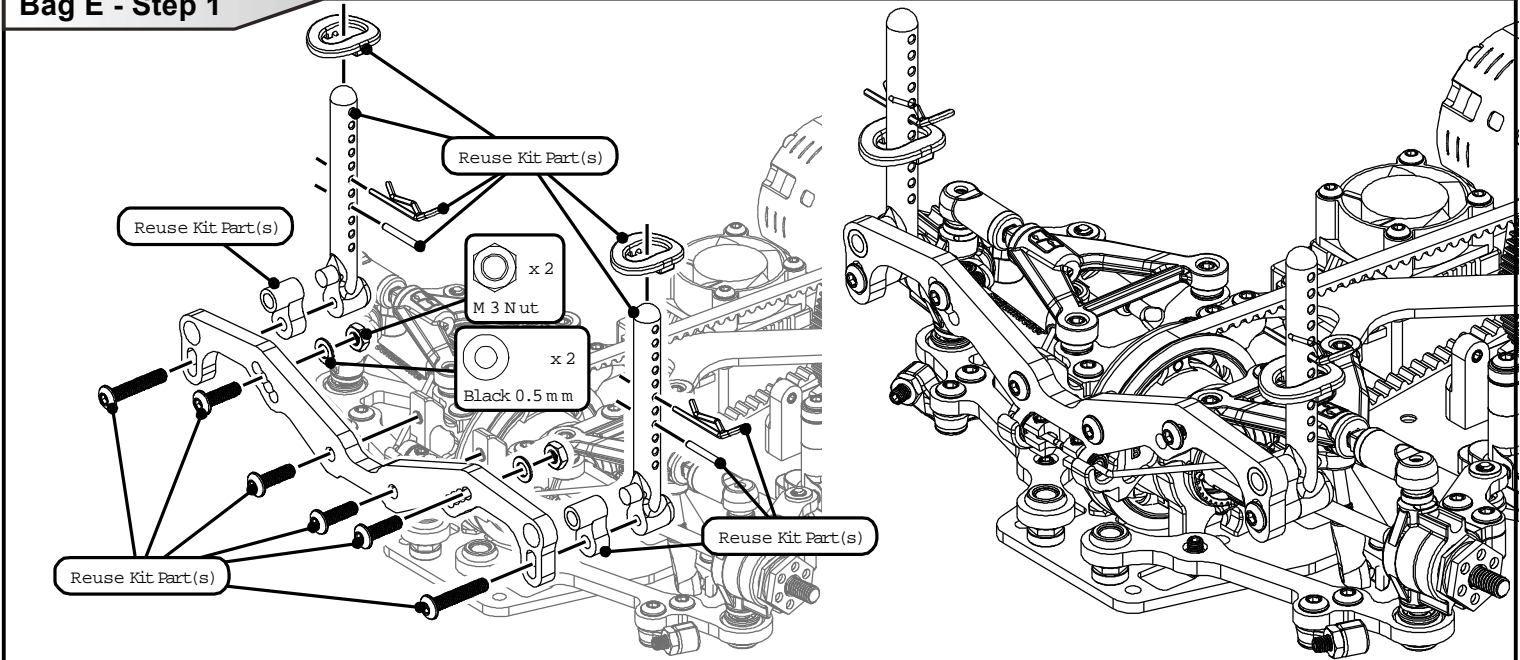

Bag E - Step 2

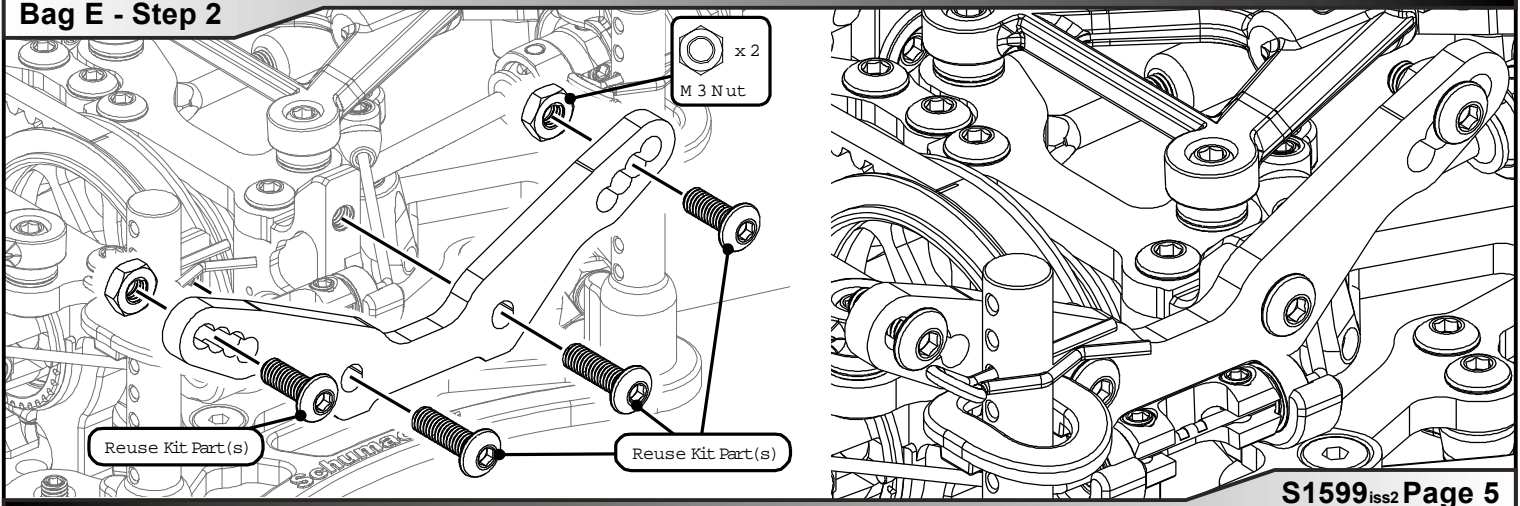

Bag E - Step 3

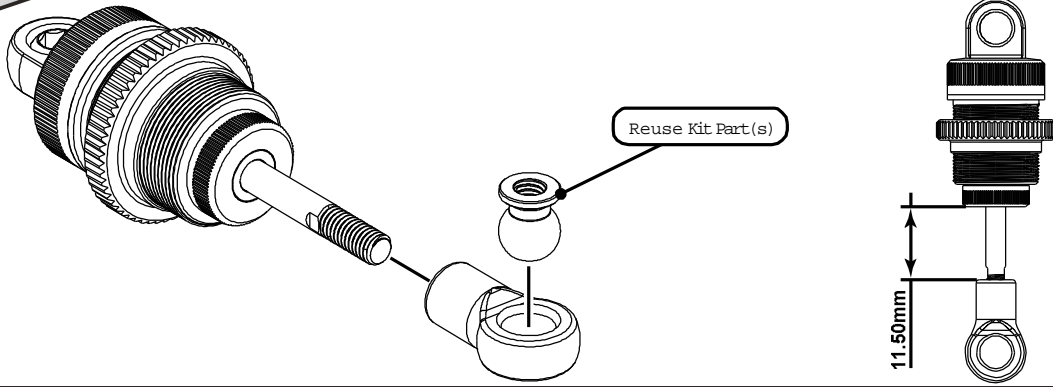

Bag E - Step 4

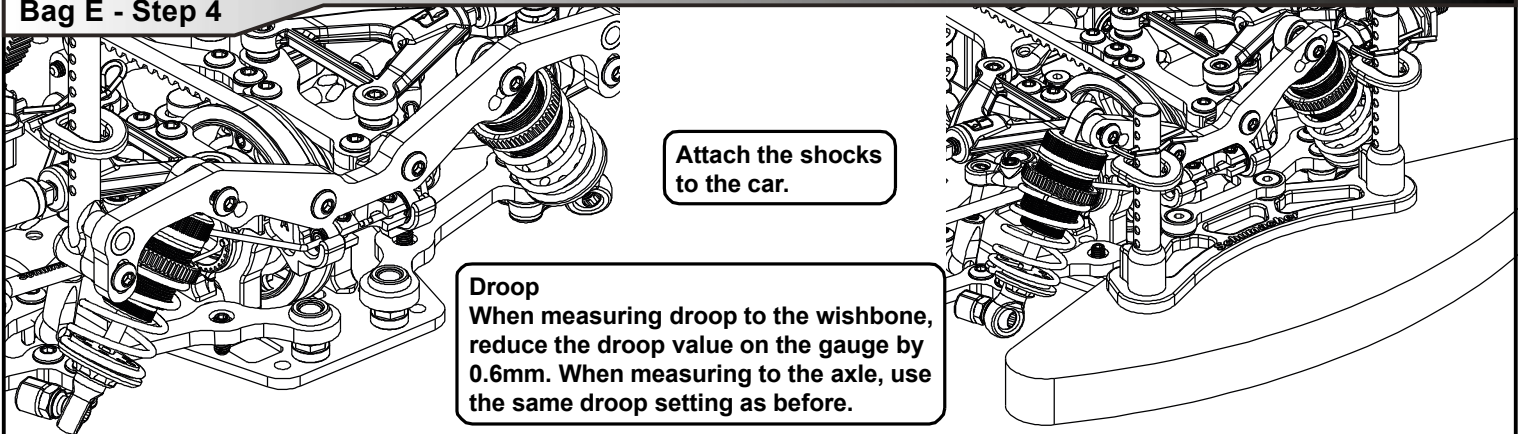

Horizontal Body Post Option

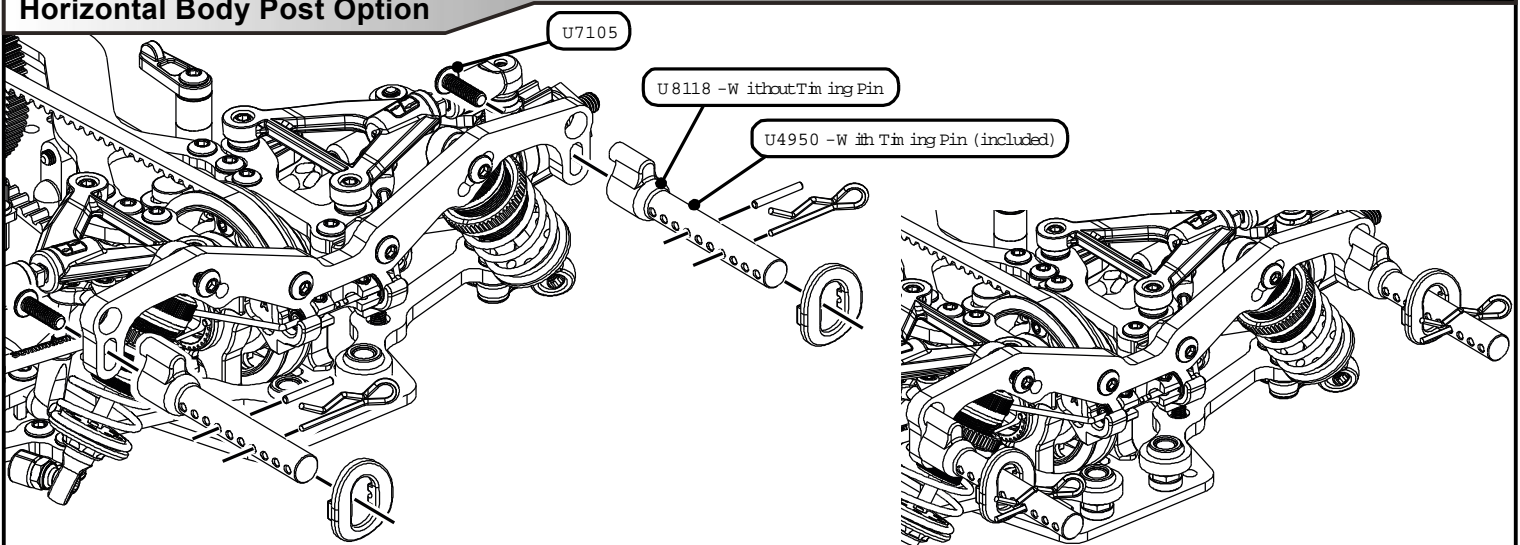

Parts List

	<p>U8162 - Front Pivot Ball Wishbones U8163 - Rear Pivot Ball Wishbones</p>		U8166 - 5.5mm Pivot Ball Socket (pk8)
	<p>U8164 - Front Shock Mount (Pivot Ball) U8165 - Rear Shock Mount (Pivot Ball)</p>		U4775 - Pivot Ball 5.5mm - (4pcs)
	U7431 - Rod End Socket (5.5mm) (pk4)		U3131 - SPEED PACK Alloy Spacers (pk18)
	U8167 - Pivot Ball Outer Socket (pr)		U4736 - Ball Stud Washer -CAT K2 - (8pcs)
			U4235 - M3 x 8mm Alloy Csk Screws pk10
			U4835 - SPEED PACK - M3 Steel Nut Black (pk8)
			U8133 - 6 x 1 'O'ring (pk10)
			U8168 - 5 x 1 'O'ring (pk10)